

| | | | | | | | | |
|-----------------------------|---|-----|-----|-----|-----|-----|-----|------|
| WT 22 SERIES STROKE LENGTH | 50 | 75 | 100 | 150 | 200 | 250 | 300 | Tol. |
| ELECTRICAL STROKE LENGTH | 50 | 75 | 100 | 150 | 200 | 250 | 300 | ±5.0 |
| MECHANICAL STROKE LENGTH | 55 | 80 | 105 | 155 | 205 | 255 | 305 | ±5.0 |
| BODY LENGTH - A | 146 | 166 | 166 | 216 | 266 | 316 | 366 | ±1.0 |
| REB CENTER TO CENTER - B | 196 | 216 | 216 | 266 | 316 | 366 | 416 | ±5.0 |
| BODY DIAMETER - D | DIA. 22 | | | | | | | |
| ROD END BEARING-C | (OPTIONAL : LINK BALL, ONE SIDE REB) | | | | | | | |
| OUT PUT SIGNALS (OPTIONAL) | 4-20 MA, 0-10 VDC MODULE, DISPLAY UNIT. | | | | | | | |
| | SPRING RETURN DEVICE (OPTIONAL FEATURE) | | | | | | | |

UNI-AUTOMATION (I) PVT LTD
 TEL/FAX: +91-(020)-24420890
 www.uniautomation.com

**CONDUCTIVE PLASTIC
 LINEAR MOTION POTENTIOMETER**

WT22-601

FIRST ISSUE : 2011/16/06

SCALE : 1:1

UAPL PART NO

149601



CUSTOMER DRAWING REF NO
 NA

CUSTOMER : UAPL STANDARD

REV -00

SHEET

1of1

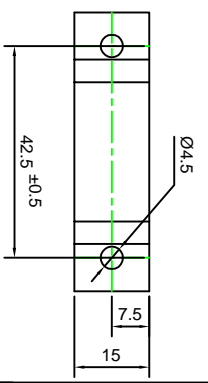

DIMENSIONS :- METRIC

ELECTRICAL SCHEMATIC DIAGRAM

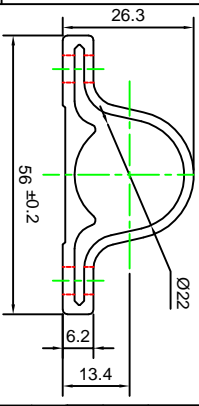

MOUNTING CLAMP (OPTIONAL)

| St. | STROKE | RESISTANCE RANGE |
|-----|--------|------------------|
| 1.0 | 50 MM | 5 KΩ ± 30% |
| 2.0 | 75 MM | |
| 3.0 | 100 MM | |
| 4.0 | 150 MM | |
| 5.0 | 200 MM | |
| 6.0 | 250 MM | |
| 7.0 | 300 MM | |

| ELECTRICAL CHARACTERISTICS | UNITS | VALUE |
|---|-----------|----------------------|
| RESISTANCE ELEMENT... | -- | CONDUCTIVE PLASTIC |
| RESISTANCE TOLERANCE... | ±% | 30 |
| STANDARD INDEPENDENT... | ±% | 0.5 |
| LINEARITY TOLERANCE... | ±% | 0.1 |
| BEST POSSIBLE LINEARITY TOLERANCE... | -- | ESSENTIALLY INFINITE |
| TEMPERATURE COEFFICIENT OF RESISTANCE(CTR)... | ppm/deg C | ±400 |
| INSULATION RESISTANCE @ 500 VDC... | M Ohms | 500 |
| DIELECTRIC STRENGTH @ 50 HZ... | V dc | 500 |
| ELECTRICAL LIFE (STROKE)... | STROKES | 5,000,000 |
| END VOLTAGE AS A % OF APPLIED VOLTAGE... | % | LESS THAN 0.5 |

| | | |
|--------------------|---------------|-------------|
| BEARING TYPE... | -- | SLEEVE |
| TORQUE STARTING... | Nmm (Oz inch) | 10 (1.416) |
| TORQUE RUNNING... | Nmm (Oz inch) | 5 (0.708) |

| | | |
|--------------------------|-----------|-------------|
| OPERATING TEMPERATURE... | DEGREES C | -40 to +105 |
| ROHS COMPLIANCE... | -- | YES |

| | | |
|------------|----|--------------------------|
| HOUSING... | -- | ALUMINIUM BLACK ANODIZED |
| SHAFT... | -- | STAINLESS STEEL |

NOTE :- CONTINUOUS IMPROVEMENTS ARE BEING MADE FOR ENHANCING PERFORMANCE FOR CUSTOMER BENEFIT IN PRODUCT DESIGN & PROCESS. THE PRODUCT SUPPLIED MAY BE SLIGHTLY DIFFERENT THAN DESCRIBED BY ABOVE SPECIFICATIONS