

DESCRIPTION	DEGREE	VOLTS
<b>Y</b> MECHANICAL	55°	5 V
<b>B</b> ELECTRICAL	45°	5 V
<b>S</b> INDEX	5°	0.2 V

**DIMENSIONS :- METRIC (INCH)**

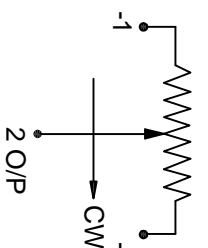
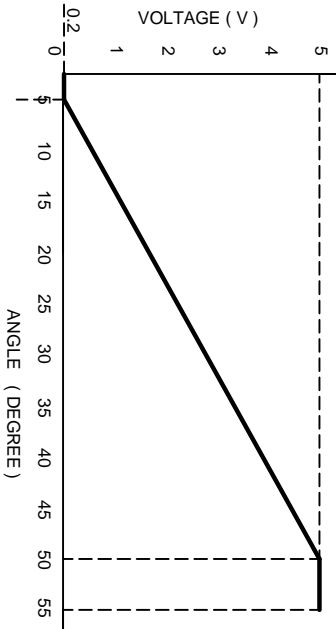
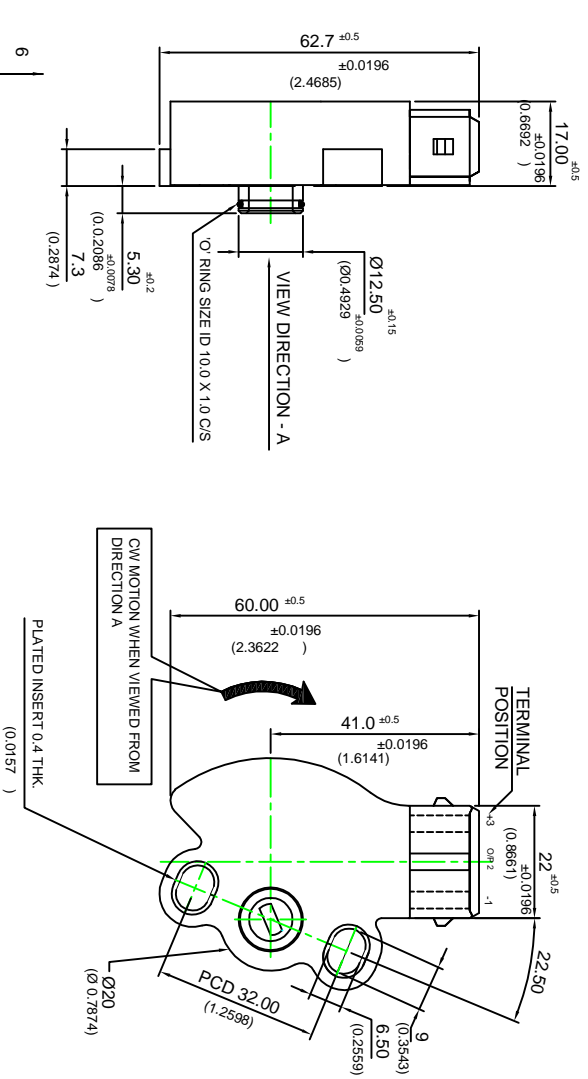

WHEN VIEWED FROM DIRECTION A  
ELECTRICAL SHEMATIC DIAGRAM

**UNI-AUTOMATION (I) PVT. LTD.**  
 TEL / FAX: +91 - (020) - 24440890  
 www.uniautomation.com

**TPS Z2**  
**CONDUCTIVE PLASTIC**  
**TPS Z2-203**

**TOLERANCE**  
 DIN-ISO 2768-M (1981-98)  
 (TOLERANCE CLASS: MEDIUM)

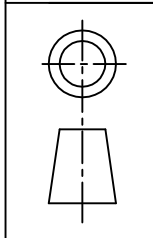

**SCALE - 1:1**  
**UAPL PART NO**  
**199203**  
**CUSTOMER DRAWING REF NO**  
 -----  
**CUSTOMER :ARAI**

FEATURES:-		
1. CONDUCTIVE PLASTIC LONG LIFE RESISTANCE ELEMENT.		
2. HIGH QUALITY ENGINEERING PLASTIC STURDY LOW PROFILE BODY.		
3. PRECIOUS METAL HIGH TECHNOLOGY WIPER GIVES NOISE FREE OUTPUT.		
ELECTRICAL CHARACTERISTICS		
RESISTANCE ELEMENT...	UNITS	VALUE
RESISTANCE VALUE...	Ohms	CONDUCTIVE PLASTIC
WIPER PROTECTION RESISTANCE ...	Ohms	5K
WIPER PROTECTION & TOTAL RESISTANCE TOLERANCE...	±%	1K
INPUT VOLTAGE...	VDC	20
INDEX POINT ANGLE ...	DEGREE	5
VOLTAGE @ Ø INDEX POINT POSITION ...	VOLT	5° ±1
INDEPENDENT LINEARITY TOLERANCE...(IEC 389)...	±%	0.2 ± 0.05
ELECTRICAL ANGLE...	DEGREES	2
RESOLUTION...	...	8.45 ± 3°
TEMPERATURE COEFFICIENT OF RESISTANCE(OR)...	ppm/deg C	ESSENTIALLY INFINITE
POWER RATING @ 70° C...	WATTS	±400
INSULATION RESISTANCE @ 500 VDC...	M Ohms	1.0
DIELECTRIC STRENGTH @ 50 HZ...	V ac	1000
MAXIMUM WIPER CURRENT ...	mAmps	500
SHORT TIME WIPER CURRENT 10 SEC...	mAmps	1.0
MECHANICAL CHARACTERISTICS :-		10
ROTATION (MECHANICAL ANGLE) WITH STOP	DEGREES	15° ± 3°
BEARING TYPE...	...	SLEEVE
TORQUE... STARTING...	Ncm(Oz in)	5 to 6(0.708 to 0.08496)
TORQUE... RUNNING...	Ncm(Oz in)	5 to 6(0.708 to 0.08496)
MOUNTING BOLT TIGHTENING TORQUE...	N.m(Oz in)	2 TO 4 (283.22 TO 566.44)
ENVIRONMENTAL CHARACTERISTICS :-		
OPERATING TEMPERATURE...	DEGREES C	-40 to +105
PERFORMANCE :-		
ROTATIONAL LIFE (SHAFT REVOLUTIONS)...	NOS.	2,000,000
MATERIALS OF CONSTRUCTION:-		
HOUSING...	--	ENGINEERING PLASTIC
TERMINALS...	--	BRASS TIN PLATED
SOLDERING RECOMMENDATION:- USE SOLDERING IRON AT 350° C FOR 3 SECOND MAXIMUM.		
CLEAN THE SOLDERED PADS WITH ISOPROPYL ALCOHOL AFTER SOLDERING.		
CONTINUOUS IMPROVEMENTS ARE BEING MADE FOR ENHANCING PERFORMANCE		
FOR CUSTOMER BENEFIT IN PRODUCT DESIGN & PROCESS, THE PRODUCT SUPPLIED		
MAY BE SLIGHTLY DIFFERENT THAN DESCRIBED BY ABOVE SPECIFICATIONS		