

Dimensions :- Metric (Inch)

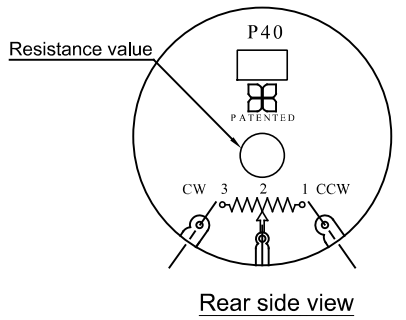
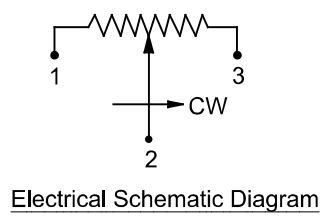
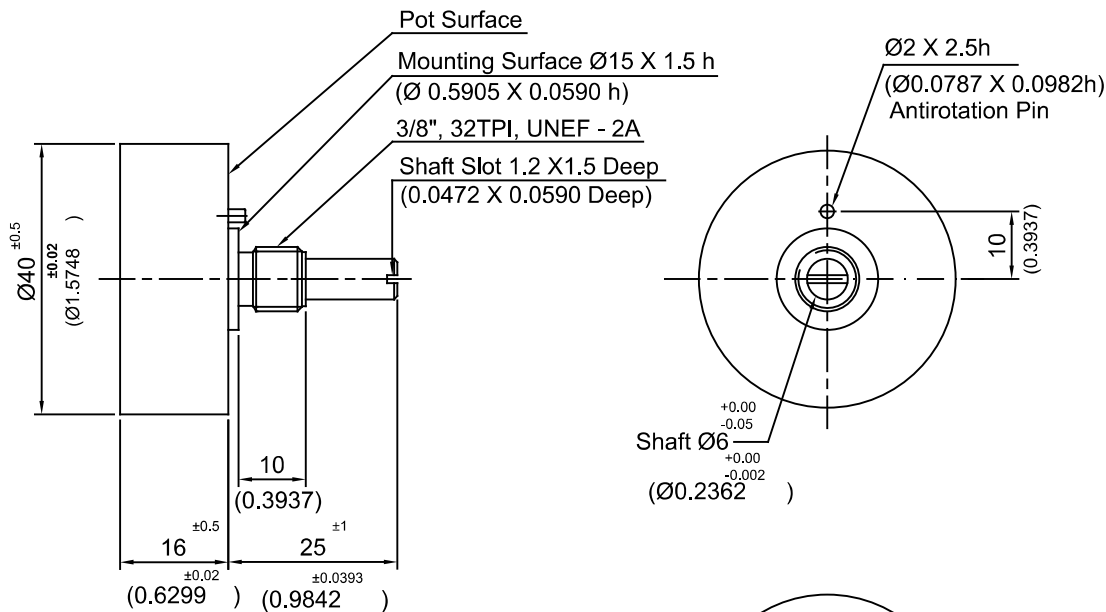

ELECTRICAL CHARACTERISTICS	UNITS	VALUE
Resistance Element...	--	Wire Wound
Resistance value...	Ohms	100, 500, 1k, 2k, 5k, 10k Other values upto 100k
Standard Resistance Tolerances...	%	$\pm 10$
Standard Independent Linearity Tolerances..(IEC 393)...	%	$\pm 0.75$
Electrical angle...	Degrees	$270^\circ \pm 5^\circ$
Equivalent Noise Resistances...	Ohms	<100
Resolution...	--	As per turns
Temperature Coefficient of Resistance (TCR)...	ppm/deg C	$\pm 50$ Up to 1k ohms $\pm 150$ for other values.
Power Rating @ 70° C...	Watts	3
Insulation Resistance @ 500 Vdc...	M Ohms	1000
Dielectric Strength @ 50 Hz...	V ac	500
Maximum Wiper current...	mAmps	1
Short time wiper current 10 sec. ...	mAmps	10
End Resistance...	%	< 0.1 OR 5 Ohms which is higher

MECHANICAL CHARACTERISTICS :-		
Rotation (Mechanical Angle). With stop...	Degrees	$285^\circ \pm 5^\circ$
Bearing Type...	-	Sleeve
Torque... Starting...	Nmm (Oz inch)	15 (2.124)
Torque... Running...	Nmm (Oz inch)	10 (1.41)
Axial Play...	m.m.(inch)	0.2 (0.00787)
Radial Play...	m.m.(inch)	0.2 (0.00787)

ENVIRONMENTAL CHARACTERISTICS :-		
Operating Temperature...	Degrees C	-40 to +105

PERFORMANCE :-		
Rotational Life (shaft Revolutions)...	Nos.	100,000

MATERIALS OF CONSTRUCTION:-		
Housing...	-	Engineering Plastics
Shaft...	-	Brass nickel plated
Terminals...	-	Brass Silver plated
Mounting Hardware ...	--	Lock Washer-steel + Nut-Brass, A/F 12.6 X 2.5 mm, both Nickel plated
Bushing...	--	Brass Nickel Plated

**Soldering Recommendation :-** Use soldering Iron at 350° C for 3 second maximum.  
 Clean the soldered pads with Isopropyl alcohol after soldering.  
 Continuous improvements are being made for enhancing performance for customer benefit in product design & process. The product supplied may be slightly different than described by above specifications

Uni-Automation (I) Pvt. Ltd.  
 Tel / Fax: +91-20-24420890  
 www.uniautomation.com

# SINGLE TURN POTENTIOMETER WIRE WOUND

## MODEL P40 (256)

FIRST ISSUE : 07/05/2015 SCALE:- 1:1  
**TOLERANCES**  
 DIN-ISO 2768-1 (1991-06)  
 (TOLERANCE CLASS-MEDIUM)

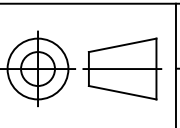

**UAPL PART NO**  
**129256**

CUSTOMER DRAWING REF NO  
 NA

CUSTOMER : UAPL STANDARD

REV - 00  
 SHEET:-1 of 1